

Product Technical Data Sheet:

**Cable Ties Bases**

**Description**

Partex self-adhesive nylon cable tie bases are designed to compliment our range of cable ties, and offer a simple and effective method of fixing.

They are supplied in bags of 100, and are available in either Black or Natural.

**Specification**

Material: Nylon 6.6 Polyamide  
 Temperature Range: -20°C to +60°C (-4°F to 140°F)

Black bases are U.V. Resistant and suitable for external conditions.

These self adhesive bases are manufactured in pairs, making removal of the backing strip much easier. The adhesive consists of a white polythene foam, coated on both sides with a high performance synthetic rubber adhesive, providing a particularly high level of instant tack combined with high shear adhesion.

Part Number	Dim A	Dim B	Dim C	Dim D
<b>HFC1/4</b>	0.8in/20mm	0.8in/20mm	0.18in/4.5mm	0.2in/5mm

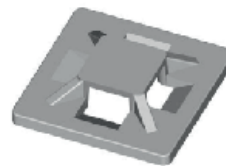
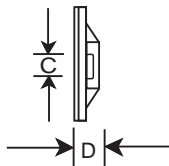
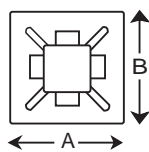

Part Number	Dim A	Dim B	Dim C	Dim D	Screw Fix (Optional)
<b>HFC2/4</b>	1.1in/28mm	1.1in/28mm	0.22in/5.5mm	0.28in/7.1mm	1/4in(M6)

